

First floor

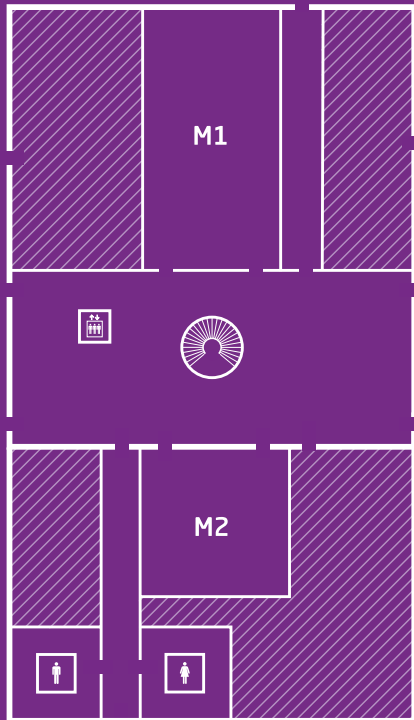

**MSc PROGRAMMES**

- M2** Biomaterial Engineering for Medicine  
11.00, 11.40, 12.20
- M2** Biomedical Engineering  
11.20, 12.00, 12.40
- M1** Human-Centered Artificial Intelligence  
11.20, 12.00, 12.40
- M1** Mathematical Modelling and Computation  
11.00, 11.40, 12.20

# FIND YOUR WAY



WANT TO WIN A PAIR OF APPLE AIRPODS 4?

**SHARE YOUR  
FEEDBACK**



**Answer the survey and join the prize draw.** You have the chance to win a pair of Apple AirPods 4. You will enter the draw once you have completed the questionnaire. The prize has a value of 1,099 DKK and cannot be exchanged for cash. The winner will be notified directly. DTU employees excluded.

**Ground floor**

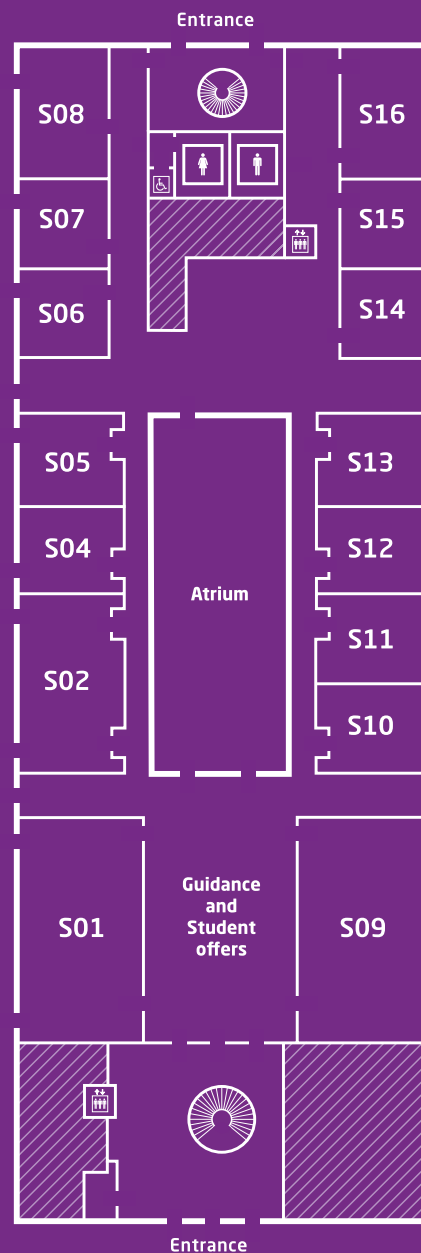

**MSc PROGRAMMES**

**S15** Applied Chemistry  
11.20, 12.00, 12.40

**S11** Architectural Engineering  
11.00, 11.40, 12.20

**S08** Autonomous Systems  
11.00, 11.40, 12.20

**S04** Bioinformatics  
11.20, 12.00, 12.40

**S10** Biotechnology  
11.00, 11.40, 12.20

**S16** Business Analytics  
11.20, 12.00, 12.40

**S05** Chemical and Biochemical Engineering  
11.00, 11.40, 12.20

**S04** Civil Engineering  
11.00, 11.40, 12.20

**S12** Communication Technologies and System Design  
11.00, 11.40, 12.20

**S01** Computer Science and Engineering  
11.00, 11.40, 12.20

**S16** Design and Innovation  
11.00, 11.40, 12.20

**S13** Earth and Space Physics and Engineering  
11.00, 11.40, 12.20

**S06** Electrical Engineering  
11.20, 12.00, 12.40

**S07** Engineering Acoustics  
11.20, 12.00, 12.40

**S06** Engineering Light  
11.00, 11.40, 12.20

**S15** Engineering Physics  
11.00, 11.40, 12.20

**S07** Environmental Engineering  
11.00, 11.40, 12.20

**S11** Food Technology  
11.20, 12.00, 12.40

**S09** Industrial Engineering and Management  
11.00, 11.40, 12.20

**S10** Industry Master  
11.20, 12.00, 12.40

**S13** Life Science Engineering and Informatics (SDC)  
11.20, 12.00, 12.40

**S02** Materials and Manufacturing Engineering  
11.20, 12.00, 12.40

**S02** Mechanical Engineering  
11.00, 11.40, 12.20

**S14** Ocean Engineering  
11.00, 11.40, 12.20

**S08** Pharmaceutical Design and Engineering  
11.20, 12.00, 12.40

**S09** Sustainable Energy Systems  
11.20, 12.00, 12.40

**S01** Sustainable Energy Technologies  
11.20, 12.00, 12.40

**S14** Sustainable Fisheries and Aquaculture  
11.20, 12.00, 12.40

**S12** Technology Entrepreneurship  
11.20, 12.00, 12.40

**S05** Wind Energy  
11.20, 12.00, 12.40

**GUIDANCE AND STUDENT OFFERS**

Career Centre

DTU Skylab

EuroTeQ

Industry Master

MSc Admissions

PF (student union)

Study Abroad

Study Guidance Office

SU Office

